



## Weller Court, Wolverhampton WV3 9EF

£1,100 Per Month



A well-appointed first floor apartment offering two double bedrooms, set within an attractive and exclusive development created through the imaginative conversion of a period property. The accommodation includes a hallway, lounge, kitchen, two double bedrooms, an en-suite shower room, a dressing room, and a main bathroom. The property benefits from allocated parking for one car, with additional visitor parking available at the front. Weller Court is ideally located close to the amenities of both Finchfield and Compton Village, and within easy reach of the picturesque open spaces of Bantock Park. Available Furnished. A payment of one weeks rent is to be paid upon acceptance of applying for the property and a security





# BERRIMAN EATON



Weller Court, Wolverhampton WV3 9EF

£1,100 Per Month



deposit of £1269.00 is payable upon completion. (EPC: C) (Council Tax Band D). All material information is readily available from the Agent or via the listing for this property on Rightmove or OnTheMarket.

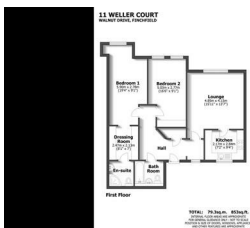

13-15 High Street, Tettenhall, Wolverhampton, WV6 8QS  
Tel: 01902 749974 Email: [lettings@berrimaneaton.co.uk](mailto:lettings@berrimaneaton.co.uk) [berrimaneaton.co.uk](http://berrimaneaton.co.uk)