



2 Westgate Villas, Salop Street, Bridgnorth, Shropshire, WV16 4QX

BERRIMAN
EATON





2 Westgate Villas, Salop Street, Bridgnorth, Shropshire, WV16 4QX

With its elegant facade, this period Victorian home enjoys a private garden to the rear, providing four double bedrooms and an extended living kitchen along with cellars, boot room and a laundry with a double width parking space to the front, walking distance to the town centre.

Much Wenlock - 7.9 miles, Telford - 13 miles, Shrewsbury - 20 miles, Kidderminster - 14 miles, Stourbridge - 15 miles, Wolverhampton - 14 miles, Ludlow - 19 miles, Birmingham - 27 miles.

(All distances are approximate)

2 WESTGATE VILLAS
SALOP STREET, BRIDGNORTH



Ground Floor



First Floor

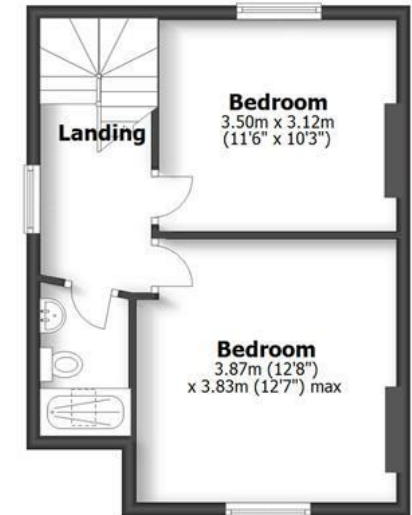

Second Floor

HOUSE: 169.8sq.m. 1,827.6sq.ft.
CELLAR: 13.7sq.m. 147.6sq.ft.
TOTAL: 183.5sq.m. 1,975.2sq.ft.
INTERNAL FLOOR AREAS ARE APPROXIMATE
FOR GENERAL GUIDANCE ONLY - NOT TO SCALE
POSITION & SIZE OF DOORS, WINDOWS, APPLIANCES
AND OTHER FEATURES ARE APPROXIMATE

LOCATION

Conveniently located within the conservation area, walking distance to the bustling High Street, this location provides the freedom to participate on foot the town's excellent range of facilities that include a large selection of independent shops, pubs/bars, cafés and restaurants. Along with a selection of primary and secondary schooling, healthcare, hospital and an array of sports facilities. There are also many historic attractions for visitors such as the Severn Valley Steam Railway, Northgate museum, funicular cliff railway and River Severn walks.

OVERVIEW

The property has been much improved over the years and has been extended to the ground floor to create a wonderful live in dining kitchen with a lantern roof lights and views across the garden along with a boot room, laundry and a guest WC. This period property retains many characterful feature with high ceilings, cast iron fireplaces, sash windows and a beautiful Victorian tiled floor to the entrance hall.

ACCOMMODATION

With a covered porch the front door opens through into the reception hall, having stairs rising to the first floor and access down to the cellar which has been tanked and is central heated. Doors lead off to a lounge having a bay window to the front elevation, oak floor and an open fireplace. The sitting room is laid with oak flooring having a feature fireplace and full height windows and a door opens through into the dining kitchen. The current owners have extended the kitchen to create a most impressive space with large sky lights and doors to the rear opening out to the rear patio terrace. With underfloor heating the kitchen area is fitted with an extensive range of base and wall cabinets, granite work tops over, inset ceramic sink and built in appliances to include fridge, dishwasher, combi microwave/steam oven, and the provision for an AGA gas cooker. Leading off the kitchen is a boot room with a door giving access to the front, and French doors opening out to the garden., laundry room with the provision for a washing machine and dryer and a guest cloakroom.

From the hall stairs rise to the first floor split level landing where there are two good sized double bedrooms, linen cupboard and a beautiful spacious family bathroom fitted with a white suite to include a walk in shower, free standing bath, WC, pedestal wash basin, heated towel rail and a feature cast iron fireplace.

A further staircase rises to the second floor where there are another two generous double bedrooms serviced by a modern shower room.

OUTSIDE

2 Westgate Villas is set back behind a block paved double width driveway having a planted border and gated side access. The rear garden has been beautifully landscaped having a stone patio extending from the kitchen with well stocked, colourful planted borders hosting a variety of mature shrubs, ornamental trees and perennials leading through to a lawned garden beyond. Within the garden there is a large secure timber shed and log store along with a timber clad pod, being insulated along with lights and power points connected creating an ideal workshop or home office.

SERVICES

We are advised by our client that all main services are connected. Verification should be obtained from your surveyor.

TENURE

We are advised by our client that the property is FREEHOLD. Verification should be obtained by your Solicitors. Vacant possession will be given upon completion.

FIXTURES AND FITTINGS

By separate negotiation.

COUNCIL TAX

Shropshire Council.

Tax Band: E.

VIEWING ARRANGEMENTS

Viewing strictly by appointment only. Please contact the BRIDGNORTH OFFICE.

Offers Around £570,000

EPC: E

IMPORTANT NOTICE: Every care has been taken with the preparation of these Particulars but they are for general guidance only and complete accuracy cannot be guaranteed. Areas, measurements and distances are approximate and the text, photographs and plans are for guidance only. If there is any point which is of particular importance please contact us to discuss the matter and seek professional verification prior to exchange of contracts.







Tettenhall Office
01902 747744
tettenhall@berrimaneaton.co.uk

Bridgnorth Office
01746 766499
bridgnorth@berrimaneaton.co.uk

Wombourne Office
01902 326366
wombourne@berrimaneaton.co.uk

Worcestershire Office
01562 546969
worcestershire@berrimaneaton.co.uk

Lettings Office
01902 749974
lettings@berrimaneaton.co.uk

BERRIMAN EATON